



SW6100 & SW07600 range

Static Welfare Units from Groundhog



The latest concept in 12 Volt technology delivers cost effective, environmentally friendly and robust Static Welfare Units from GenQuip in partnership with Groundhog

Accommodating Sustainable Innovations

SW 6100 Static Welfare Units

The new Static Welfare Accommodation range from Groundhog are stylish and have distinctive anti-vandal exterior, with four curved corners that create an individual appearance with built in Hoglift.

SW 6100 Standard

The standard SW 6100 is lightweight and compact, which meets HSE requirements and provides all your on-site needs in one compact cost effective package. The units are suitable for accommodating eight people, which provides pleasant and safe working environments, ideal for rental companies and contractors. Once lifted into position, they provide a vandal resistant facility and can come with a number of additional money saving features.

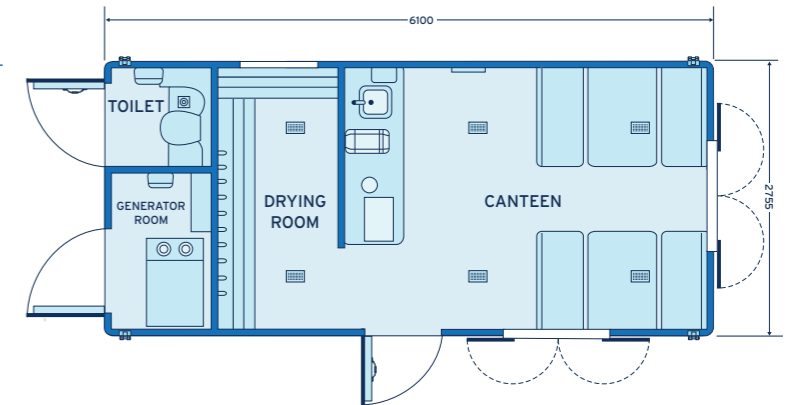

SW 6100 Fusion

The Fusion offers the legendary robustness and ease of use of the standard unit but provides a green environmental solution. Giving owners and end users savings by way of reduced fuel usage, 60% reduction in generator servicing, longer generator life, fewer breakdowns and massively reduced noise pollution.

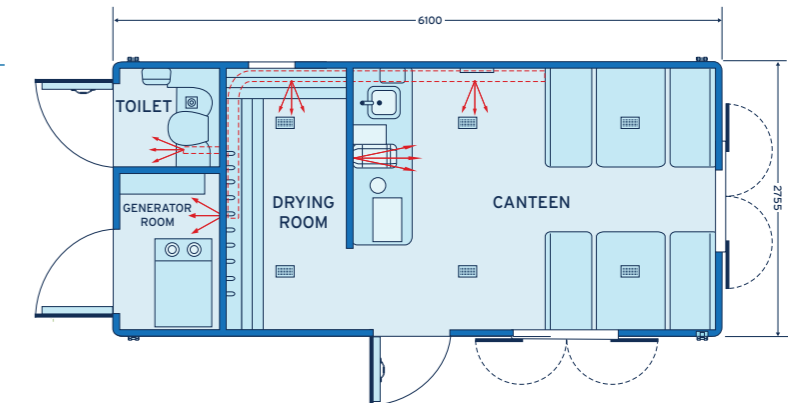

SW 6100 Fusion Plus

The Fusion Plus will offer further cost savings as the hot water is supplied by an on board system and will not require the generator to run. Therefore the generator will only be required for microwave and kettle. Additional savings will be found in winter especially if used overnight by security personnel who can utilize the unit with heating and lighting without running the generator.

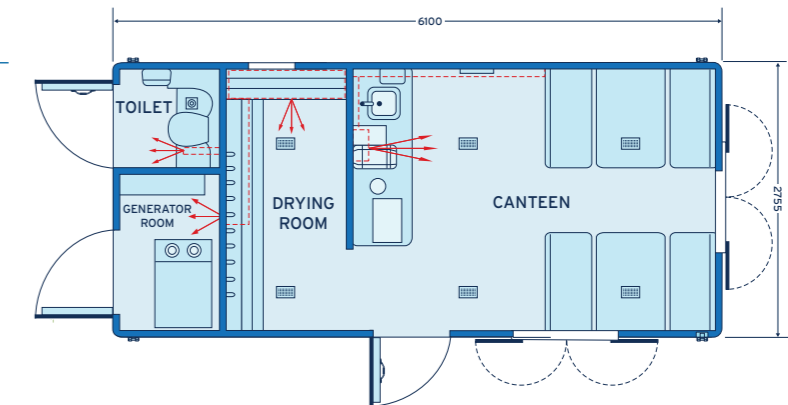

1 Canteen/Seating Area

- 1 x High Capacity Battery
- Battery charger Centaur 12 Volt 30amp
- 12 Volt L.E.D. Light c/w P.I.R. Sensor
- 1 x Battery guard
- Diesel powered Airtop System (Fusion)
- Diesel powered Thermotop System (Fusion +)
- Generator Auto-timed control which will be factory set at 2 hours
- Frost Stat (Fusion range only)

2 Drying Room

- 12 Volt L.E.D. Lighting
- Diesel powered Heating system
- Coat hooks

3 Generator Room

- 6KVA Super Silent Diesel Generator with exhaust venting pipe
- 200 Litre Diesel tank with filler neck and level gauge
- 12 Volt L.E.D. Lighting

4 Toilet Area

- Flush Ceramic 12 Volt Toilet System (Optional)
- Plastic Recirculating Toilet c/w ventilation pipe
- Forearm wash basin with warm water tap (Fusion+)
- Toilet roll holder
- 12 Volt L.E.D. light
- Ventilation panel
- Paper towel & soap dispenser
- 12 Volt mini handwash (Fusion)

5 Office Area

- Aluminium sliding window with steel sliding shutters, which when closed are secured internally
- White Board
- Office table and chair
- Thermostat heating
- 12 Volt L.E.D. Light c/w P.I.R. Sensor

Both units have the option of a Flush Toilet

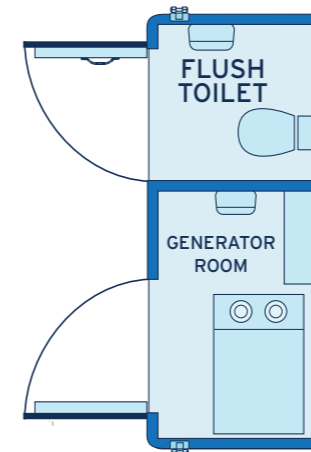

Units are manufactured in two sizes. The SW6100 (6100mm x 2755mm) or the larger SW0 7600 (7600mm x 2755mm) with the added benefit of an office facility.

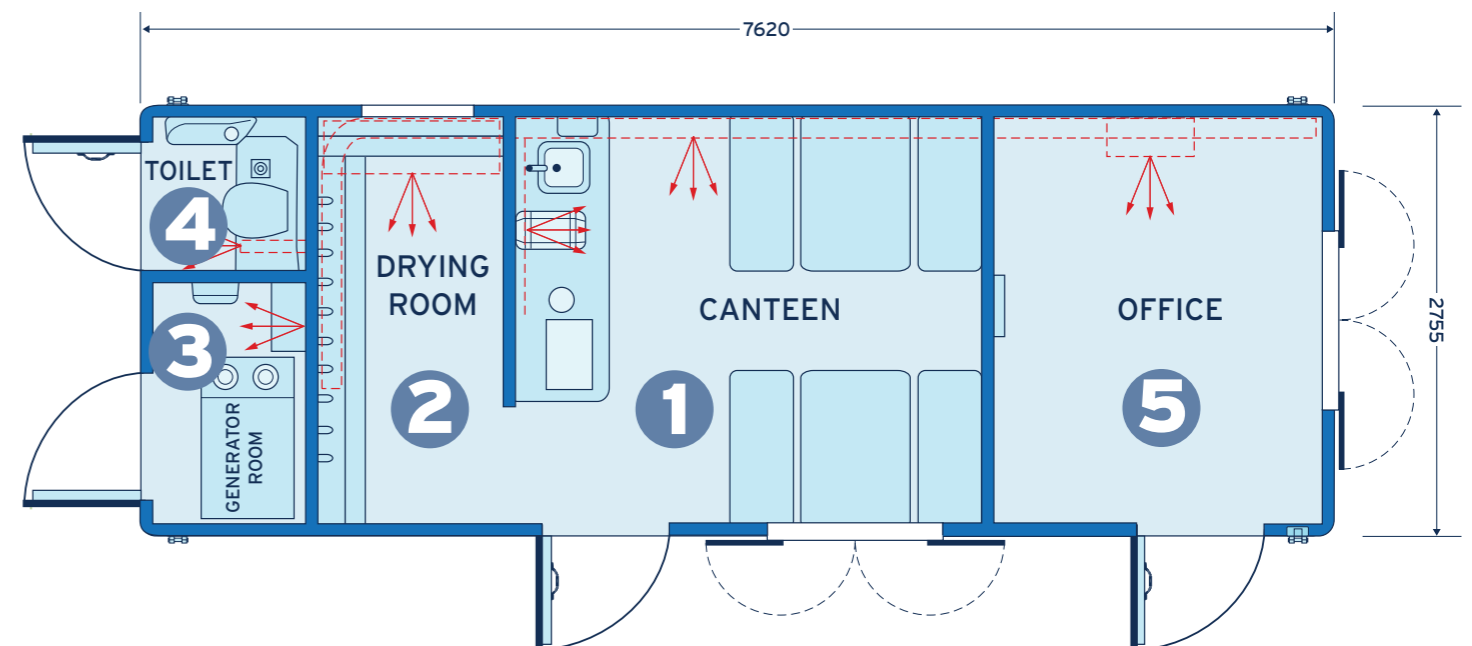
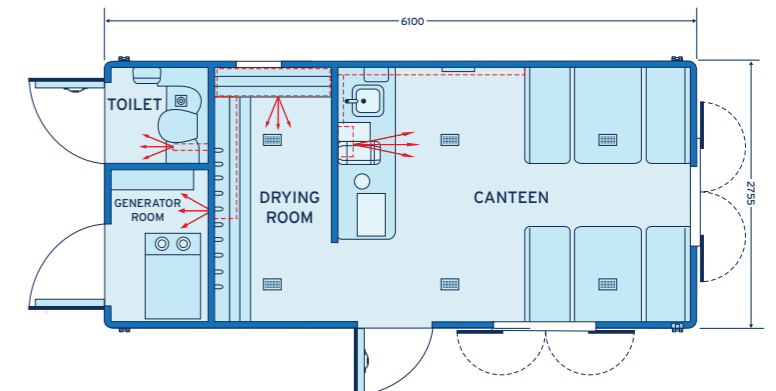

Canteen & Seating Area

The canteen area has well equipped amenities such as, work surface with stainless steel sink/drain, cutlery trays, triple hand wash dispenser and fresh drinking water, and appliances which include a microwave and kettle.

The rest area provides comfortable bench seating for up to eight people

- 1 x High Capacity Battery
- Battery charger 12 Volt 30amp
- 12 Volt L.E.D. Light c/w P.I.R. Sensor
- 1 x Battery guard
- Diesel powered Airtop System (Fusion)
- Diesel powered Thermotop System (Fusion +)

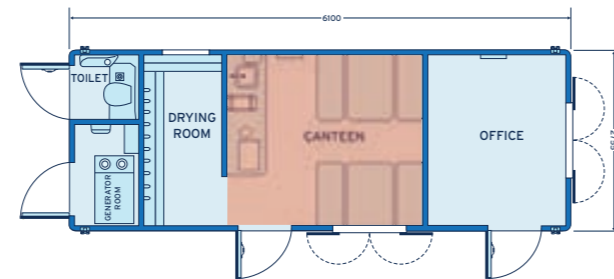

Rest area that provides comfortable bench seating for up to eight people



Surprisingly light and spacious canteen area (Fusion+)



Heating On/Off switch and Battery Indicator



Hot Air heating control Frost Stat (Fusion range only)



LED Lights (Fusion)



Generator Start/Stop control panel

SW6100 & SW07600 range

Generator & Toilet Area

Generator

The generator room is fitted with a 6KVA super silent diesel generator, which significantly reduces noise levels, the generator has a 200 litre diesel tank complete with filler neck and level gauge.

- 12 Volt L.E.D. Lighting
- Ventilation panel
- 6KVA Super Silent Diesel Generator with exhaust venting through roof
- 200 Litre Diesel tank with filler neck and level gauge

Toilet

The w/c is fitted with a plastic recirculating toilet with ventilation pipe and wash basin. The Fusion+ model comes equipped with a forearm wash basin with warm water tap.

- Flush Ceramic 12 Volt Toilet System (Optional)
- Plastic Recirculating Toilet c/w ventilation pipe
- Forearm wash basin with warm water tap (Fusion+)



Forearm wash basin and Toilet



Generator & Toilet Area

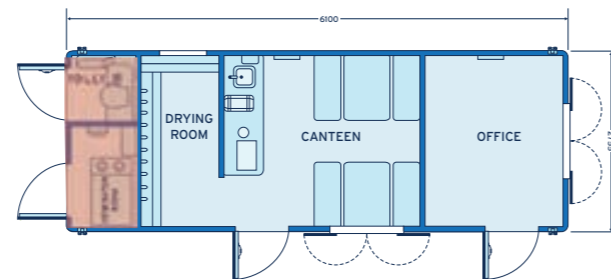

Easily accessible Generator

Office & Drying Area

Office Area

Light and spacious, the Office Area includes Thermostat Heating and 12 Volt LED Lighting

- Aluminium sliding window with steel sliding shutters, which when closed are secured internally
- White Board
- Thermostat heating
- 12 Volt L.E.D. Light c/w P.I.R. Sensor

Drying Area

The Drying Area is ideal for drying wet work clothing, and incorporates the Diesel powered Heating System and a Frost Stat, the room also offers Coat Hooks and 12 Volt LED lighting

- 12 Volt L.E.D. Lighting
- Diesel powered Heating system
- Coat hooks



Office Area

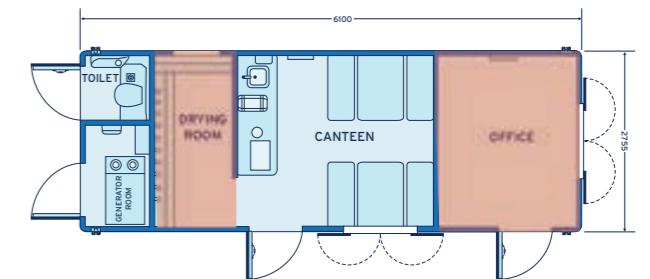

Drying Area

SW6100 & SW07600 range

Hoglift 1 & Hoglift 2

The unique Hoglift 1 and 2 system enables units to be lifted onto vehicles without the operator leaving ground level, contributing to Health and Safety.

The **Hoglift 1** system includes four sliding channels (Galvanised), complete with sliding trolley skates. These trolley skates are electroplated and have lifting rings which can be utilised for securing the container to the vehicle whilst transporting.



Hoglift 1

The **Hoglift 2** system has a reinforced steel cable which is permanently fixed at the top of the unit while the opposite end has rings that are fastened to flat webbings for lifting.

Both systems Include pre-drilled plates to enable the units to be double stacked and bolted together and are both rated to 8.8 tonnes.



Hoglift 2

Features

Canteen

	6100/7600 Fusion	6100/7600 Fusion Plus
Table and bench seating for up to 8 persons	●	●
Diesel powered Heating and Hot Water		●
Heating system (hot air blowers)	●	
Microwave/Kettle	●	●
Fresh & waste water containers (20 Ltr cap each)	●	●
Hot water tap set over large wrist to elbow sink		●
12 Volt L.E.D. Lighting PIR	●	●
Double 13amp socket outlet	●	●
Consumer Board c/w RCD & MCB's	●	●
Generator control panel with hour run meter	●	●
Paper towel dispenser	●	●
Liquid soap dispenser	●	●
Disposable cup dispenser	●	●
Carbon monoxide monitor	●	●
Forklift Pockets	●	●
Fresh drinking water container (20 Ltr)	●	●
Storage Area under counter	●	●
Low battery warning light and Volt Meter	●	●
240 Volt Hot water	●	
Battery Guard	●	●

Generator / Drying Room

12 Volt L.E.D. Lighting PIR	●	●
Diesel powered Heating system (Blown Air)	●	●
Coat hooks	●	●
6 KVA Diesel Generator with exhaust venting through roof area	●	●
Access to fuel tank complete with fuel level gauge (200 Ltr cap)	●	●

Toilet Area

Standard Recirculating Toilet c/w ventilation pipe	●	●
Full arm wash basin (Hot Wash)		●
12 Volt mini handwash	●	
Toilet roll holder	●	●
12 Volt L.E.D. lighting PIR	●	●
Ventilation panel	●	●

Optional Extras

Starter/Safety Kit	●	●
Painted in clients corporate colour scheme	●	●
Externally mounted pneumatic light mast	●	●
Rain harvesting system (flush toilet models)	●	●
Full flush 12 Volt toilet complete with fresh water tank (60 Ltr) & effluent tank (100 Ltr)	●	●
Fuel Active - Fuel Delivery System	●	●
Hoglift 2 system	●	●
PV Solar panel	●	●



Many safety features and vandal resistant



Value Proposition

Potential yearly savings for the Fusion range

(based on units running 8 hour day and 5 day week)

- ✓ Minimum fuel savings of up to £2,000
- ✓ CO2 emissions saving of over 17,335 KGs
- ✓ Generator service cost saving of £1,750
- ✓ Potential breakdown costs saving of £1,200
- ✓ Low noise pollution

Fusion range, C rated - 73 Energy Performance Asset Rated

The SWO Fusion Range has been Energy Performance Asset Rated which indicates the energy efficiency of the building fabric, heating, cooling and lighting systems ventilation, making it an exceptionally Eco friendly.





Green Innovation

For more information contact our Sales Team

Peter Beach on **07825 526461**

Sales on **01639 823484**

or **peter@genquip.co.uk**.

sales@genquip.co.uk.

